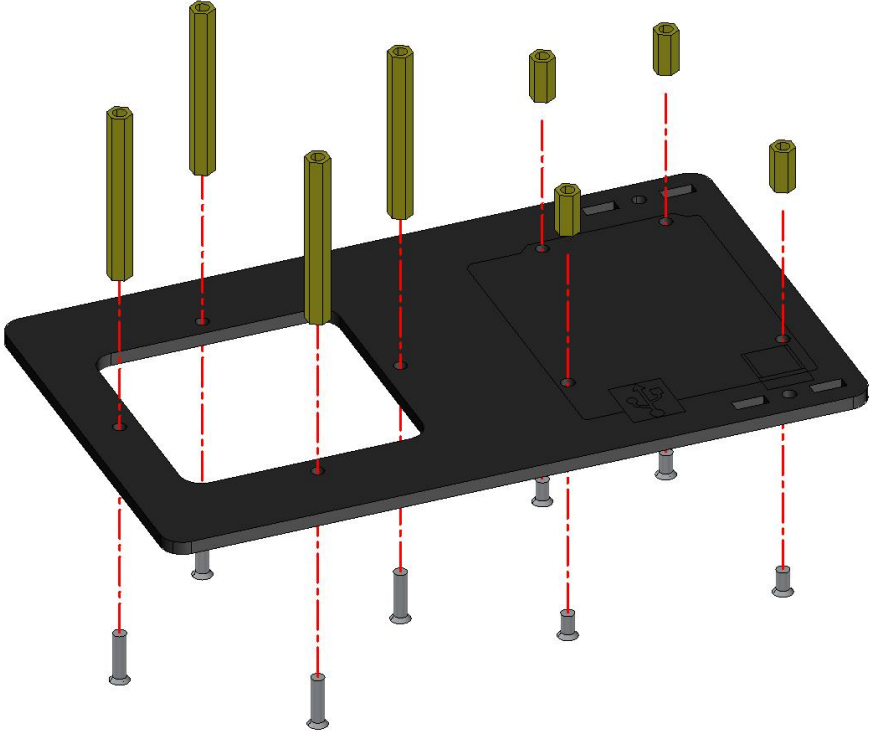
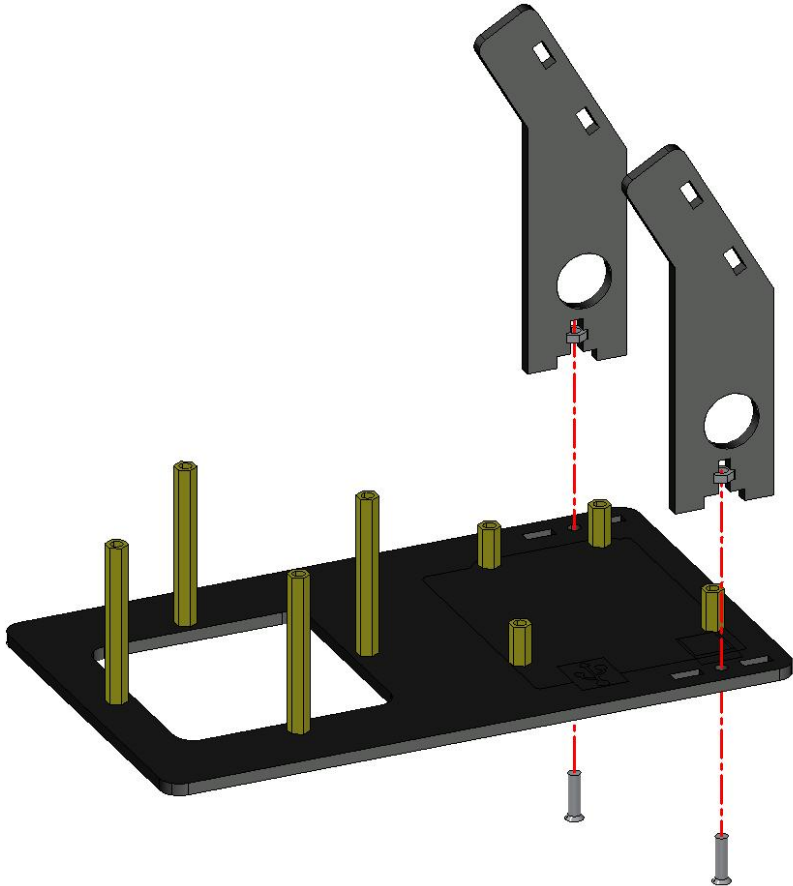
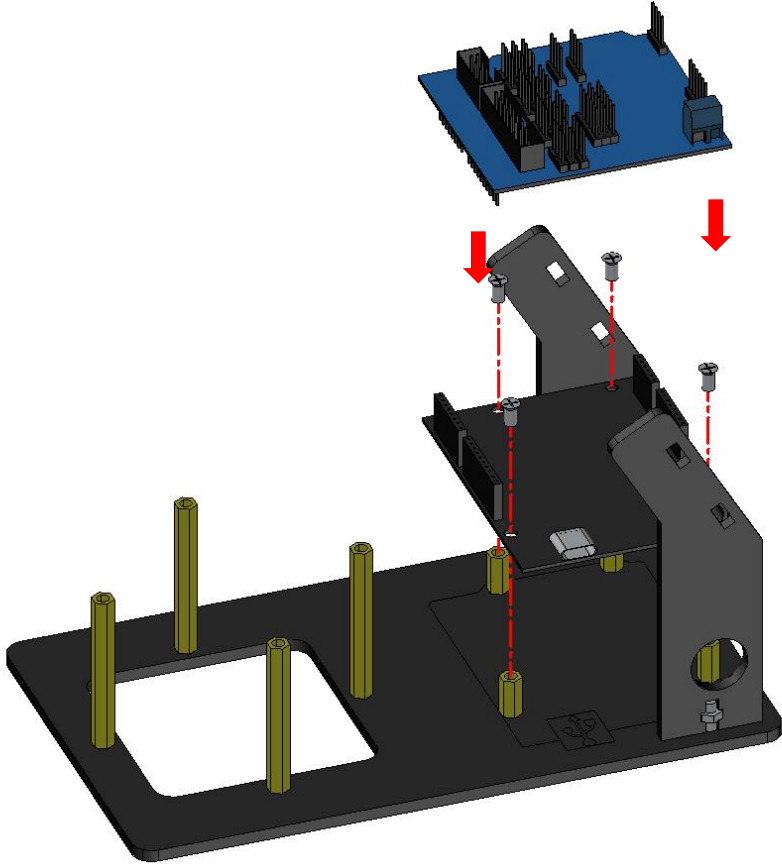

Radar-cat assembly guide

Step 1 Installation Of Copper Pillar			
Parts List	Acrylic Base Plate *1	M3*10 Countersunk Cross Screw *4	M3*6 Countersunk Cross Screw *4
	M3*40 Double Pass Copper Column *4	M3*10 Double Pass Copper Column *4	
Splicing Diagram			
	1.Note that the short copper column matches the short screw.		

Step 2 Mounting Support Frame			
Parts List	Support Frame Acrylic *2	M3*10 Round Head Cross Screw *2	M3 Nut *2
Splicing Diagram			
Notes	<p>1. First, clamp the nut to the corresponding hole position;</p> <p>2. Insert the acrylic support into the bottom plate and lock the screw;</p> <p>3. Pay attention to the orientation of the bracket.</p>		

Step 3 Install The Control Board And Extension Board

Parts List	Control Board*1	Extension Board*1	M3*6 Countersunk Cross Screw *4
Splicing Diagram			
Notes	<p>1. Pay attention to the installation direction of the motherboard and the expansion board, and do not blindly force the installation of the expansion board, and do not insert it backwards.</p> <p>2. If the screw of the motherboard is too difficult to screw on, you can not screw, 3 is also enough.</p>		

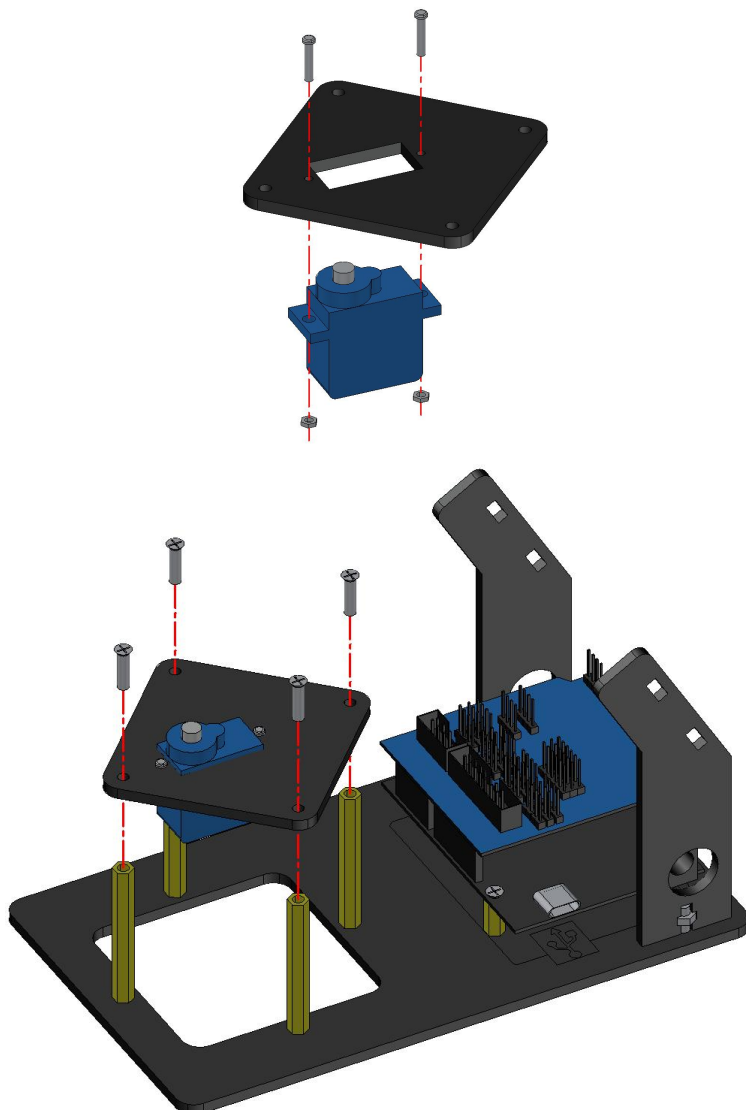
Step 4 Install Servo Motor			
Parts List	Actuator Acrylic Bracket *1	Servo Motor*1	M2*10 Round Head Cross Screw *2
	M2 Nuts*2	M3*10 Countersunk Cross Screw *4	
Splicing Diagram			
Notes	<div>1. Fix the servo on the servo bracket first;</div> <div>2. Install the installed servo support to the corresponding copper column position;</div> <div>3. Pay attention to the direction of the servo.</div>		

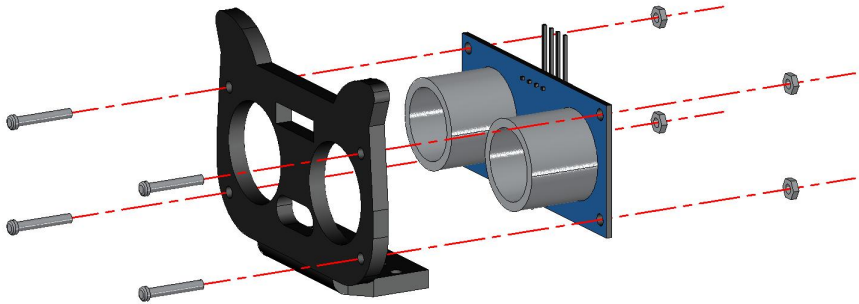
Step 5 Install Ultrasonic Module		
5.1		
Parts List	Ultrasonic Bracket *1	Ultrasonic Module *1
	M1.6*10 Round Head Cross Screw *4	M1.6 Nuts *4
Splicing Diagram		
Notes	1. Pay attention to the orientation of the ultrasonic module.	

Step 5 Install Ultrasonic Module		
5.2		
Parts List	The Assembled Ultrasonic Bracket *1	Servo Rocker Arm *1
	M1.4*5 Self-Tapping Screw *2	Small Screw For Servo Motor *1
Splicing Diagram		
Notes	<p>1. First, fix the steering wheel on the support through two self-tapping screws;</p> <p>2. Insert the support installed with the steering wheel into the steering gear;</p> <p>3. Use the fixed screw of the servo to fix it .</p>	

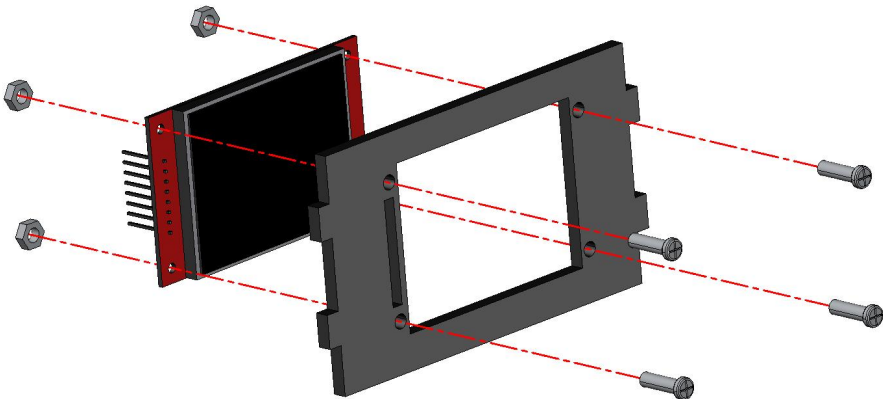
Step 6 Installation Of The Display			
Parts List	LCD Display*1	M3*10 Countersunk Cross Screw *4	M3 Nuts *4
Splicing Diagram			
Notes	<p>1. Pay attention to the installation of the display screen is not upside down, and pay attention to align the side with the hole.</p>		

Step 7 Wiring

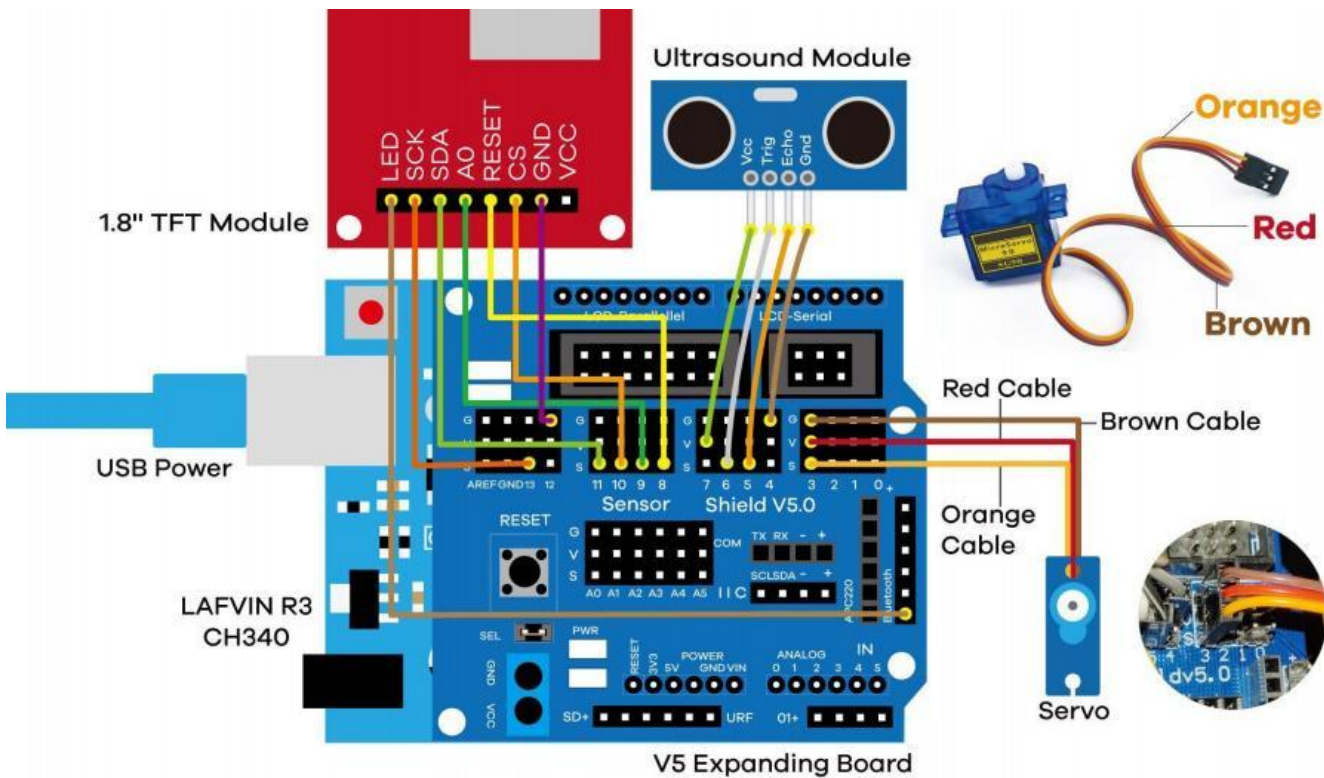
Parts List	7 Pin Dupont Wire	4 Pin Dupont Wire
Splicing Diagram	 <p>The diagram illustrates the wiring for a V5 Expanding Board. Key components and their connections are as follows:</p> <ul style="list-style-type: none"> 1.8" TFT Module: Connected to the board's headers. Pins are labeled LED, SCK, SDA, A0, RESET, CS, GND, and VCC. USB Power: Provides power to the system. LAFVIN R3 CH340: A USB-to-UART bridge chip connected to the board's headers. Ultrasonic Module: Connected to the board's headers. Pins are labeled Vcc, Trig, Echo, and Gnd. Servo: A blue servo motor connected to the board's headers. It is powered by a Red Cable and a Brown Cable, and its signal is connected to an Orange Cable. V5 Expanding Board: The central component with various headers including AREF, GND, 5V, RESET, PWR, SD+, and ANALOG. <p>Color-coded cables are used for the servo: Red, Brown, and Orange.</p>	
Notes	<p>1. Focus on identifying the position of each line.</p>	

Step 8 Fixed Display Screen

Parts List

Assembled Display Stand *1

Splicing
Diagram

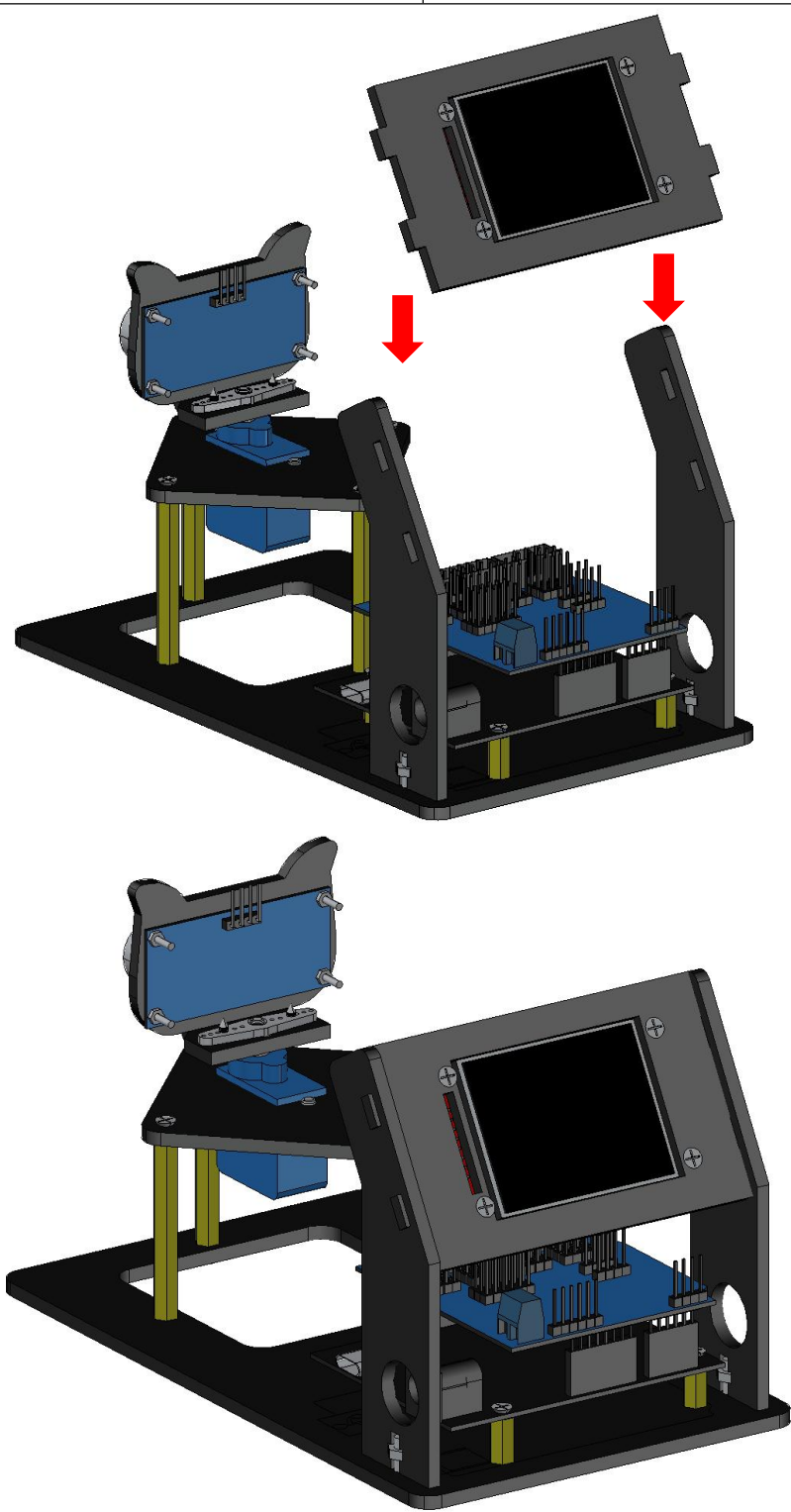

Notes